



NATIONAL ARTS COUNCIL
SINGAPORE

OPEN CALL FOR 2024 TRADITIONAL ARTS RESIDENCY AT STAMFORD ARTS CENTRE

ABOUT TRADITIONAL ARTS RESIDENCY

In its fifth edition, the Traditional Arts (TA) Residency supports the incubation of new and innovative content with a traditional performing arts focus. It aims to provide a more structured training to equip TA artists with capabilities to propel their artmaking to the global arena, and create opportunities for artists to establish networks with key players in the local arts scene and beyond.

The residency invites individuals, groups or collectives primarily practising Traditional Arts to collaborate with artists from other artistic disciplines, to experiment and incubate a **new work that is intercultural and/or cross-disciplinary in nature, with plans for international dissemination**. The residency spans for a duration of 5 months, from **1 June 2024 to 31 October 2024**¹. The residency should culminate in a showcase or presentation by the end of the residency period.

The residency will be awarded to a maximum of **3** artist(s)-in-residence. For this edition, selected artists-in-residence will receive **funding, access to shared working space**², as well as **support from an overseas mentor – Long Play Lab (LPL)**. LPL will oversee and provide tailored feedback on the artistic developments of the project, as well as conduct a 6-module curriculum for the artists-in-residence. Artists-in-residence will be able to leverage on LPL's extensive networks and experience in the cultural and creative industries and learn how to pitch their works on the global arena.

In addition, there may be opportunities for artists-in-residence to tap on the network of traditional arts groups housed in Stamford Arts Centre (SAC) and hence are encouraged to carry out exchanges with these arts groups. Situated in the vibrant and dynamic district of the Waterloo Arts Belt, this residency also offers proximity to the rich repository of resources in the National Library and arts institutions like the Nanyang Academy of Fine Arts and Lasalle College of Arts.

THE LONG PLAY LAB TEAM

Helmed by Topi Lehtipuu and Ivan Ludlow, [Long Play Lab \(LPL\)](#) is a strategic cultural think tank that designs training and strategy programmes for cultural institutions and government departments. The team is interested in cross-cultural dialogue and multi-disciplinary approaches to artistic creation and the adaptability and relevance of traditional art forms. Both directors have a wealth of experience in performing, programming and producing, as well as an extensive international network of cultural executives and practitioners.

¹ The 5-month residency period includes a scheduled break that is subject to confirmation upon discussion with LPL after the Letter of Offer (LOO) acceptance. The schedule of the residency will be designed in a tailor-made fashion according to the needs of each artist/project.

² Awarded artists-in-residence will not have full access to the working space for the entire duration of the residency. Estimated number of hours of studio access will be worked out after LOO acceptance.



Topi enjoys a career as an artistic consultant, festival director and curator, and is also a classical singer of international renown. He was the director of the Helsinki Festival, the largest multi-arts festival in the Nordic countries, where he commissioned and curated new works of all artistic disciplines. Topi has overseen a reorganisation of the various festivals in Helsinki and has advised a wide range of cultural organisations, including one of the world's top music universities, Sibelius Academy.



Ivan has long combined his international performance career with one as an artistic director (Opera Faber Festival in Portugal), project producer, teacher and cultural advisor. His recent work focused on the conception of multi-arts educational institutions, showcases for performing arts projects and the development of new approaches to distribution and remuneration in the music industry. Ivan's film production company, New Studios, uses the artistry of today's stage performers to tell extraordinary stories on all aspects of culture and performance through cinematographic content.

ELIGIBILITY

The main applicant needs to be primarily practising Traditional Arts, with at least 2 years of relevant experience working in the arts. The collaborator(s) may be from other artistic disciplines/ practices/ fields.

Who may apply?

- Individuals** who are Singapore Citizens or Permanent Residents (PR); or
- Organisations** that are either registered with ACRA (including Non-Profit / Non-Government / Community-based organisations / sole proprietorship / limited liability partnership (LLP) / Company Limited by Guarantee (CLG) / Private Limited Company) or a society registered with the Registry of Societies at the time of application; or
- Informal groups or collectives** (of up to four members) in which the majority of members are Singapore Citizens or PR³. The Primary Applicant will have to undertake legal and financial responsibility on behalf of the collective.

Who may not apply?

- If your group or collective is constituted for non-secular purposes.
- If you and/or any member of your collective have outstanding evaluation reports or deliverables from previous NAC grants, at the time of this application.
- If you and/or any member of your collective have outstanding debts with the NAC at the time of this application.
- If you are a student.

A note on Funding Guidelines

While we celebrate diversity of expression and open, balanced dialogue in the arts, as a statutory body disbursing public funds in line with Government policies, NAC has to prioritise funding to proposals which do not:

³ For example, for a collective with four members, three members must be Singapore citizens or PR.

- Advocate or lobby for lifestyles seen as objectionable by the general public;
- Denigrate or debase a person, group or class of individuals on the basis of race or religion, or serve to create conflict or misunderstanding in our multicultural and multi-religious society;
- Undermine the authority or legitimacy of the government and public institutions, or threaten the nation's security or stability.

RESIDENCY PACKAGE

What support is available per project?

1. A **grant of up to S\$30,000⁴**, which comprises support for:
 - a. Up to S\$20,000 covering the artist-in-residence and collaborator's honorarium, research and other relevant costs associated with the residency; and
 - b. Up to S\$10,000 for Project Showcase expenses;
2. **Mentorship guidance and support by Long Play Lab (LPL)**, with the following tentative schedule:
 - a. At least 1 week of in-person sessions at SAC with LPL per month;
 - b. In the remaining time, the artist(s)-in-residence are to independently work on their projects at SAC (subject to availability), while being in contact with LPL remotely;
 - c. 1 scheduled break¹ within the 5-month residency period;
 - d. Note: The mentoring sessions may be in the form of group sessions with all the artist(s)-in-residence or conducted separately, depending on the needs of the artists/projects. The schedule is tentative, and it will be subject to changes upon discussion with LPL after the Letter of Offer (LOO) acceptance;
3. A rent-free (utilities included) **studio space** fitted with air-con and lights⁵ for 5 months, shared amongst all the artist(s)-in-residence, subject to availability.

KEY DELIVERABLES

The awarded artists-in-residence are expected to commit 5 months, from June 2024 to October 2024, and achieve the following outcomes:

1. Develop a new work that is intercultural and/or cross-disciplinary in nature, with a Traditional Arts focus or is rooted in Traditional Arts practices;
2. Ensure 100% attendance for all mentorship/ curriculum sessions with LPL and any other subject specialist engaged by LPL, unless in the event of unforeseen circumstances (LPL and NAC to be notified in a timely manner and relevant documentation to be furnished);
3. Documentation of residency progress through email updates to NAC after the 2nd month and the 4th month;
4. Put up a work-in-progress (WIP) Showcase towards the end of the residency⁶;
5. Work closely with LPL to connect with an international festival/platform, to pitch the new work created through this residency; and

⁴ For grants of \$10,000 and above, the artist-in-residence will also need to submit Statement of Accounts certified by an accountant registered with the Institute of Singapore Chartered Accountants (ISCA) or equivalent international body. Accounting fees for this statement can be budgeted for in your application.

⁵ Please refer to **Appendix B** for the SAC studio space specifications.

⁶ Finalised details for Project Showcase should be submitted to NAC and LPL latest 1 month before the end of the residency.

6. Submit a Post-Residency Report and Financial Report, submitted within 2 months of the Residency’s completion.

NAC reserves the right to review, withdraw or withhold any funding and support in full or in part if any of the deliverables are not met.

HOW ARE APPLICATIONS ASSESSED

Applications will be evaluated by both NAC and LPL. There will be a shortlisting process and shortlisted candidates will be invited to attend an interview. The final decision on the outcome of the application and funding will be made by NAC.

The assessment will be guided by the following criteria:

- The applicant’s **artistic track record and potential** in contributing to traditional arts practice
- The approaches and methods outlined in the applicant’s proposal – **artistic strength and potential for international markets**
- Demonstration of **good project management** through the proposal

SUBMISSION

When and how to submit an application?

All applications must be submitted by **31 January 2024, Wednesday (11.59pm)**. Incomplete and/or late applications will not be considered.

RESIDENCY PERIOD	APPLY BY	NOTIFIED BY
5-month period from 1 June 2024 to 31 October 2024	31 January 2024	29 March 2024

A **full** application includes the following:

1. Completed application form ([Annex A](#))
2. Budget Form ([Annex B](#))
3. Curriculum Vitae of main applicant and all collaborators
4. Two samples of past works by applicant *or* link to portfolio
5. *Optional: Any other supporting documents, which can give us a better understanding of your current body of works*

TERMS AND CONDITIONS OF PARTICIPATION

By submission of the Residency application form, the applicant agrees to all of the abovementioned guidelines as well as the following terms and conditions:

1. The National Arts Council reserves the right to record all or part of the proceedings of the Residency and related activities for broadcast and promotional purposes without payment to the applicants or the applicants’ consent. National Arts Council retains all rights to the recorded materials.

2. Any applicant who knowingly gives inaccurate or misleading information will be disqualified.
3. In case of any disputes, the National Arts Council's decision shall be final and no discussion or correspondence will be entertained.
4. The National Arts Council reserves the right to amend the rules and terms and conditions of the Residency at any time.

Appendix A – About Stamford Arts Centre

Stamford Arts Centre (SAC) is located within the neighbourhood of the Arts Heritage District and Waterloo Arts Belt. It is envisioned as a vibrant and energetic arts centre focused on bringing the traditional arts closer to the community, supporting content creation and artistic collaborations, and the use of digital technology. Besides being a space for the arts, the Residency will support the role of the Centre in connecting communities, and bringing to life the shared experiences and memories of the residents and spaces in the locale.

SAC comprises of three blocks of building connected with a walkway on the second storey. The blocks are served by two lifts allowing easy accessibility throughout the Centre. The Centre comprises a multi-purpose hall (Black Box), an acoustically treated music studio, artist residency studio and several shared facilities.

Appendix B – SAC Studio Specifications

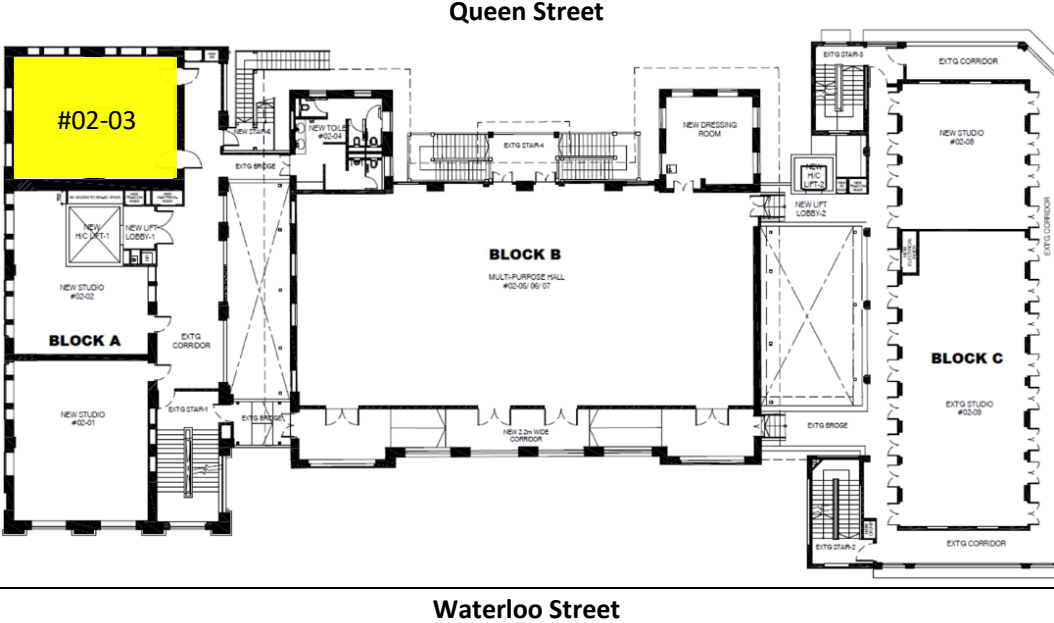

Unit	#02-03
Area	710 sqf / 66 sqm
Utilities	Air-con, lights, acoustically treated walls and raised carpeted floor
Opening hours	9am – 10pm ² , daily